

Some medication or medical conditions can affect your pregnancy test result:

- Always read the manufacturers' instructions for any medication you are taking before conducting the test.
- Fertility drugs containing hCG can give misleading results (these fertility drugs are usually given by injection, and testing too soon after administration may give a false 'Pregnant' result).
- Other fertility therapies (such as clomiphene citrate), painkillers and hormonal contraceptives (e.g. contraceptive pills) should not affect the result.
- If you have recently stopped taking hormonal contraception or are using fertility therapies like clomiphene citrate, your periods may be irregular, leading you to test too soon.
- If you have recently been pregnant (even if not carried to full term) you may get a false 'Pregnant' result.
- Ectopic pregnancy, ovarian cysts, menopause and some very rare medical conditions can give misleading results.
- If you have a 'Pregnant' result it is possible that you later find that you are not pregnant due to natural loss of the pregnancy which can occur in the early stages.

If you do get unexpected results you should discuss them with your doctor.

Clearblue Advanced Fertility Monitor allows you to test for pregnancy, by detecting the pregnancy hormone, hCG, in your urine. It has been shown in laboratory testing to be over 99% accurate in detecting pregnancy from the day the period is due.

Clearblue recommend that you test from the day your period is due. However, the pregnancy hormone increases rapidly in early pregnancy and Clearblue Advanced Fertility Monitor can be used to test for pregnancy up to 3 days before your period is due. In clinical testing with early pregnancy samples Clearblue Advanced Fertility Monitor gave the following results:

Number of days before the period is due	% of samples from pregnant women giving a 'Pregnant' result
-1	96%
-2	91%
-3	74%

Clearblue

ADVANCED
Fertility Monitor
Pregnancy Tests



These tests must only be used to test for pregnancy using the Clearblue Advanced Fertility Monitor. They cannot be used with any other Clearblue monitor. You must read the instructions supplied with your monitor before using these tests. When using the monitor for the first time you will need to set a new cycle before testing for pregnancy.

If you have lost your monitor instructions you can request a replacement by calling the Clearblue Careline, or download a copy from www.clearblue.com.

How accurate is Clearblue Advanced Fertility Monitor?

Clearblue Advanced Fertility Monitor has been shown in laboratory testing to be over 99% accurate in detecting pregnancy from the day the period is due.

English

Your pregnancy test result



Your result is 'Pregnant' and you should see your doctor who will advise you on next steps.



Your result is 'Not pregnant'. It may be that you are not pregnant, or if you have tested before your period is due it may be that the level of pregnancy hormone is not high enough to be detected by the test. Test again when your period is due.

If you test on the day your period is due and the result is still 'Not pregnant' you may wish to test again in 3 days time. If this test gives you a 'Not pregnant' result and you still have not had your period, see your doctor.

Testing errors

If an error occurs during testing the screen will display an error message. Refer to the monitor instruction booklet for further information.

Clearblue is a trade mark.

Manufacturer: SPD Swiss Precision Diagnostics GmbH,
Route de St Georges 47, 1213 Petit-Lancy,
Geneva, Switzerland.
© 2013 SPD Swiss Precision Diagnostics GmbH.
All rights reserved.

Keep out of the reach of children.

For *in vitro* diagnostic use. **IVD**

This test is for home use.

Not to be taken.

Not for internal use.

Store in a dry place at room temperature.

Do not use a test if the foil wrapper containing it is damaged.

Do not use a test that has passed its expiry date.



0843

www.clearblue.com

Advisors available 07:00 – 15:00hrs Mon-Fri,
excluding Bank Holidays.

UK - 0845 6076596 • IE - 1890 882 885

Call charges vary; please check with your provider.
Please be ready to quote the **LOT** number.
Calls are recorded for training and quality control.

	Manufacturer		Do not reuse
LOT	Batch code	IVD	<i>In vitro</i> diagnostic medical device
	Use by Date		Temperature limitation 2°C - 30°C

Testing

The monitor will only request fertility tests. It will estimate when your period is due, but you may test for pregnancy on any day providing you have set a new cycle. You can test once during your testing window, however, if you get an error you may test again using a new test. If you want to collect your urine to test later, for example if you need to go to the toilet before your testing window starts, use a clean, dry container and store it at room temperature until you are ready to test. Remember to test within the testing window.

- When you are ready to test select the correct test. Pregnancy tests are in white foil.



- Open the foil and take the test out and use immediately.



Do not hold the test with the absorbent sampler pointing upwards as the result may be affected.

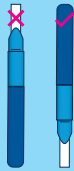

- Choose your method of testing:

In your urine stream

Put just the absorbent sampler pointing downwards into your urine stream for **3 seconds only**.



OR

Dipping

Collect a sample of your urine in a clean, dry container and put just the absorbent sampler into the urine, as shown, for **15 seconds only**.



- Take the cap off.



- Place the cap over the absorbent sampler. Wipe off any excess urine.

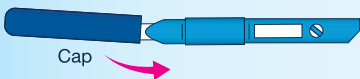

- Insert the test into the monitor immediately. If the monitor is switched off, turn it back on and **wait for the Clearblue screen to disappear before inserting the test.**

- Find the test slot.

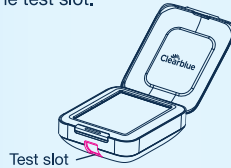

- Hold the monitor flat, or place it on a flat surface.

- Insert the test so the cut corner is on the bottom edge of the test and the coloured side of the test is on the right hand side of the test slot.

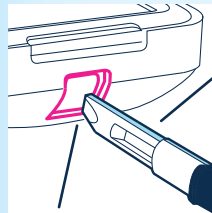

Cut corner facing down

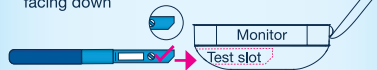

- Push the test in until you hear a click.

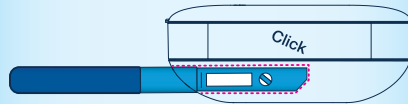

DO NOT

Do not insert the absorbent sampler into the monitor.



Do not insert with the cut corner pointing upwards.



Do not insert the cap into the monitor.

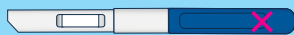

- The monitor will confirm the test is inserted correctly and identify whether it is a fertility or pregnancy test. Once this process is complete a countdown screen will appear.

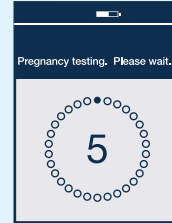

Do not remove the test during the countdown. If you remove the test too early an error will be displayed.

The screen will switch off after 1 minute, but the monitor will continue to analyse the test. The test light will flash.

- Wait 5 minutes for your result.

- If you switch the monitor back on, the screen will display how long you have to wait. The alarm will sound when testing is complete and the light will stop flashing.

- If the monitor is off, switch it back on and remove the test.

- Read your result. The result can only be read on the monitor and cannot be worked out by any lines you might see on the test.

- Dispose of the test with your normal household waste. You must not reuse a test.